

# Stand Components

**Flat Top SSN 290**  
For use on models 50-B,  
51-A & 51-B  
Made of cast iron.



**Forged Crank SSN 251**



**Adjustable Shim Set SSN 210**  
For use on  
models 51-A,51-B



**Cover SSN 200**  
For use on models  
51-A & 51-B. Made  
of malleable iron.



**Breakable Crank SSN 250**



**SSN 220**  
For use on Switch  
Stands. Made of  
forged steel.



**Ring SSN 994**  
This ring serves  
as a lock for  
cross pin.



**Cross Pin SSN 994**  
Special Shear-resistant  
steel.



**Adjustment Bolt SSN 996**  
For use on  
Models 51-A  
and 51-B



**Adjustable Gear Segment SSN 300**  
For use on Model 51-A.  
Made of malleable iron.



**Latch Stand SSN 230**  
For use on all  
switch stands.



**Bottom SSN 295**  
For use on all Switch  
Stands. Wide, heavy  
base of cast iron.



**Bow Handle SSN 223**  
For use on all Switch Stands.  
Optional colors available.



**Top Extension SSN 292**  
For mast support on  
switch stand models  
50-B and 51-B



**Throwing Lever SSN 225**  
A rolled steel lever, assembled  
with pinion gear for Models 50  
and 51. 30 pound cast iron  
weighted handle.



# Stand Components

## Plug Lamp Tip SSN 270

For use with low stands. The plug lamp tip fits directly into the segment tube on top of the stand and takes the place of the usual target mast. The target used is correspondingly low.



## Socket Lamp Tip SSN 270

For use over the mast on low or intermediate stands. The socket end fits over the top of the mast.



## Target Masts SSN 280

For Low Models 50-A and 51-A.  
Length: 1' 0<sup>5</sup>/<sub>8</sub>"



## Targets for 51-A SSN 240

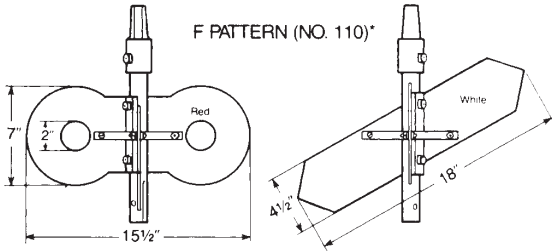

## Connecting Rods for 51-A SSN 260



Model 11AN



Model 11TN

